

Water Certification

Name: North Hudson Community Head Start
5800 Kennedy Blvd.
West New York, NJ 07047
Phone:

Inspection Address: 5800 Kennedy Blvd
West New York, NJ 07047

Inspection date: January 23, 2024

Water Outlet Tested:	Lower Level / Kitchen / Sink	Pass
	Lower Level / Kitchen / Sink	Pass
	Lower Level / Kitchen / Sink	Pass
	Lower Level / Girls bath / Sink #2	Pass
	Lower Level / Boys bath / Left sink	Pass
	Lower Level / Boys bath / Right sink	Pass
	Lower Level / Classroom / Sink	Pass
	1 st floor / Classroom / Right sink	Pass
	1 st floor / Classroom / Left sink	Pass
	1 st floor / Classroom / Right sink	Pass
	1 st floor / Classroom / Left sink	Pass
	1 st floor / Classroom / Right sink	Pass
	1 st floor / Classroom / Left sink	Pass
	1 st floor / Classroom / Bath sink	Pass
	1 st floor / Classroom / Sink	Pass
	1 st floor / Girls bath / Sink	Pass
	1 st floor / Bath / Sink #2	Pass
	2 nd floor / Bath / Right sink	Pass
	2 nd floor / Bath / Left sink	Pass
	2 nd floor / Bath / Right sink	Pass
	2 nd floor / Bath / Left sink	Pass

EPA Standard: Copper <1300 PPB Lead <15 PPB

Certification: Drinking water meets EPA Standards
See reports from (Phoenix Environmental Laboratories, Inc.)

Operator License: 00121-E

G. Luke Schroeder
NJ dept of Health ID# 001537



PHILIP D. MURPHY

Director
LOCATION
101 S BROAD ST
TRENTON NJ 08616

STATE OF NEW JERSEY
DEPARTMENT OF COMMUNITY AFFAIRS
DIVISION OF CODES AND STANDARDS
LEAD HAZARD UNIT

LT. GOVERNOR STEPHEN L. OLIVER

COMPTROLLER
MAILING ADDRESS
101 S BROAD ST
TRENTON NJ 08616

Certificate - Lead Evaluation Contractor

RECERTIFIED

This is to certify that the Department of Community Affairs has certified

LEAD CONSULTING & INSPECTION
219 MAIN STREET, BOX 814
CHATHAM NJ 07928

To act as a Lead Evaluation Contractor on the following Projects

Residential
Public Buildings
Comm/Steel Structure

Cert #: 00121-E
Effective Date: 6/1/2023
Expiration Date: 5/31/2025
Certificate Type: 2 YEAR

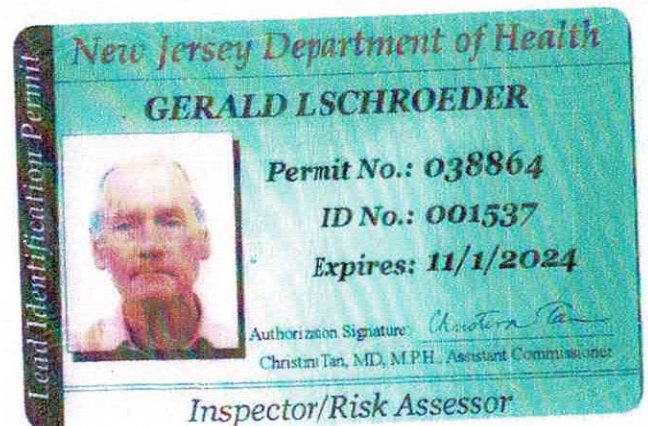

State of New Jersey
Department of Children and Families
Office of Licensing

DRINKING WATER TESTING CHECKLIST

Note: This form is for child care centers that are supplied water by a community water system.

•PROGRAMS IN OPERATING PUBLIC SCHOOLS ARE NOT REQUIRED TO COMPLETE THIS FORM•

CHILD CARE CENTER INFORMATION

Name of Child Care Center: North Hudson Community Head Start			License ID: 09NOR0003	
Site Address of Center:	Building # and Street: 5800 Kennedy Blvd.	Municipality: West New York	County: Hudson	
Sponsor/Sponsor Representative: Jay Johnson		Phone Number: (201) 428-4278	Email: jjohnson@nhcac.org	

CERTIFICATION OF COMPLIANCE WITH LEAD & COPPER SAMPLING AT THE ABOVE CHILD CARE CENTER

Sampling Date(s):	JAN 23, 2024
1. <input checked="" type="checkbox"/> YES <input type="checkbox"/> NO	Does the center have a signed contract with a New Jersey Certified Drinking Water Laboratory for lead & copper analysis?
2. <input checked="" type="checkbox"/> YES <input type="checkbox"/> NO	Is there an onsite water outlet assessment in accordance with technical guidance?
3. <input checked="" type="checkbox"/> YES <input type="checkbox"/> NO	Is there a floor plan in accordance with technical guidance?
4. <input checked="" type="checkbox"/> YES <input type="checkbox"/> NO Sample Date: JAN 23, 2024	Were all the drinking water outlets in the center where a child or staff has or may have access (including food preparation and outside drinking water outlets) sampled?
5. <input type="checkbox"/> YES <input type="checkbox"/> NO Sample Date: JAN 23, 2024	Were at least 50% of all indoor water faucets utilized by the center sampled?
6. <input checked="" type="checkbox"/> YES <input type="checkbox"/> NO	Does the child care center have the chain of custody and analytical reports for all drinking water outlets sampled? Please attach copies.
7. <input checked="" type="checkbox"/> YES <input type="checkbox"/> NO	Was all the drinking water outlets sampled in the sequence determined by the floor plan beginning with the outlet closest to the point of entry?
8. <input checked="" type="checkbox"/> YES <input type="checkbox"/> NO	Were all samples taken after the water sat undisturbed in pipes for at least 8 hours but no more than 48 hours?
9. <input checked="" type="checkbox"/> YES <input type="checkbox"/> NO	Were samples collected in pre-cleaned high density polyethylene (HDPE) 250 ml wide mouth single use rigid sample containers?
10. <input checked="" type="checkbox"/> YES <input type="checkbox"/> NO	Were all existing aerators, screens, and filters left in place prior to and during the sampling event?
11. <input checked="" type="checkbox"/> YES <input type="checkbox"/> NO	Were only cold water samples collected?
12. <input checked="" type="checkbox"/> YES <input type="checkbox"/> NO	Did no pre-stagnant flushing take place unless the outlet deviated from normal use and documented on flushing log?
13. <input checked="" type="checkbox"/> YES <input type="checkbox"/> NO	Was all point of use treatment on outlets, such as filters, documented?
14. <input type="checkbox"/> YES <input checked="" type="checkbox"/> NO	Did any result exceed the action level for lead (15 µg/L) or copper (1300 µg/L)?
15. <input type="checkbox"/> YES <input type="checkbox"/> NO <input checked="" type="checkbox"/> N/A	If a result exceeded the action level for lead (15 µg/L) or copper (1300 µg/L) was use of all drinking water outlets immediately discontinued?
16. <input type="checkbox"/> YES <input type="checkbox"/> NO <input checked="" type="checkbox"/> N/A	If a result exceeded the action level for lead (15 µg/L) or copper (1300 µg/L) was bottled water provided for drinking and food preparation?
17. <input type="checkbox"/> YES <input type="checkbox"/> NO <input checked="" type="checkbox"/> N/A	If a result exceeded the action level for lead (15 µg/L) or copper (1300 µg/L) were signs posted to indicate that the outlets are not to be used for drinking or food preparation?

18. <input type="checkbox"/> YES <input type="checkbox"/> NO <input checked="" type="checkbox"/> N/A	Did all drinking water outlets with a result that exceeded the action level for lead (15 µg/L) or copper (1300 µg/L) have a follow-up flush sample conducted?
19. <input type="checkbox"/> YES <input type="checkbox"/> NO <input checked="" type="checkbox"/> N/A	If a result exceeded the action level for lead (15 µg/L) or copper (1300 µg/L) was the local health office notified of results?
20. <input type="checkbox"/> YES <input type="checkbox"/> NO <input checked="" type="checkbox"/> N/A	If any of the results exceeded the action level for lead (15 µg/L) or copper (1300 µg/L), was notification, including results and remediation measures, provided to the parent(s) of all children attending the center, the staff, and NJDCF?
21. <input type="checkbox"/> YES <input type="checkbox"/> NO <input checked="" type="checkbox"/> N/A	Were any drinking water outlets or potable plumbing replaced or repaired as a remedy for an action level exceedance?
22. <input type="checkbox"/> YES <input type="checkbox"/> NO <input checked="" type="checkbox"/> N/A Sample Date: JAN 23, 2024	If any drinking water outlet or potable plumbing was replaced or repaired, were additional samples collected after installation?
23. <input type="checkbox"/> YES <input type="checkbox"/> NO <input checked="" type="checkbox"/> N/A	Was any chemical treatment unit or process installed to remedy an action level exceedance (e.g., corrosion control treatment)?
24. <input type="checkbox"/> YES <input type="checkbox"/> NO <input checked="" type="checkbox"/> N/A Sample Date: JAN 23, 2024	If a chemical treatment unit or process was installed to remedy an action level exceedance (e.g., corrosion control treatment), were additional samples collected after the installation?
25. <input type="checkbox"/> YES <input type="checkbox"/> NO <input checked="" type="checkbox"/> N/A	Was a mechanical process implemented to remedy an action level exceedance (e.g., flushing program)?
26. <input type="checkbox"/> YES <input type="checkbox"/> NO <input checked="" type="checkbox"/> N/A	If a mechanical process was implemented to remedy an action level exceedance (e.g., flushing program), were additional samples collected after the implementation?
27. <input type="checkbox"/> YES <input type="checkbox"/> NO <input checked="" type="checkbox"/> N/A	If no remedial action was taken, such as those indicated in 21 through 26 above, has the center implemented a written plan of action for use of bottled water for drinking and food preparation?

CERTIFICATION: By signing below, the **Sponsor or Sponsor Representative** certifies that all answers on this checklist are true and accurate:

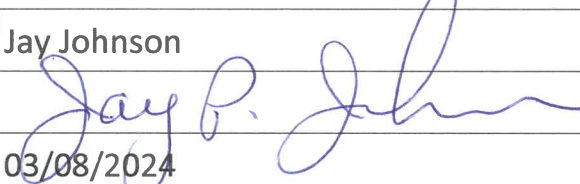
Sponsor/Sponsor Representative: (PRINT)	Jay Johnson
Signature:	
Signature Date:	03/08/2024

DRINKING WATER TESTING RESOURCES

Schools - Lead Sampling Information

<http://www.nj.gov/dep/watersupply/schools.htm>

Lead Sampling in Schools Technical Guidance FAQs

<http://www.nj.gov/dep/watersupply/pdf/leadfaq.pdf>

3Ts for Reducing Lead in Drinking Water: Testing

<https://www.epa.gov/dwreginfo/3ts-reducing-lead-drinking-water-testing>

Quick Reference Guide Sampling For Lead in Drinking Water in Schools:

<http://www.nj.gov/dep/watersupply/pdf/quickref.pdf>

List of NJ Certified Laboratories:

<https://www13.state.nj.us/DataMiner/Search/SearchByCategory?isExternal=y&getCategory=y&catName=Certified+Laboratories>

Drinking Water Outlet Inventory Form:

http://www.nj.gov/dep/watersupply/doc/SP_Attachment%20C.docx

Sampling Water Use Certification:

http://www.nj.gov/dep/watersupply/doc/SP_Attachment%20F.docx

Filter Inventory Form:

http://www.nj.gov/dep/watersupply/doc/SP_Attachment%20D.docx

Results Letter Template:

<http://www.nj.gov/dep/watersupply/doc/resultsletter.doc>

State of New Jersey
Department of Children and Families
Office of Licensing

DRINKING WATER TESTING STATEMENT OF ASSURANCE

• PROGRAMS IN OPERATING PUBLIC SCHOOLS ARE NOT REQUIRED TO COMPLETE THIS FORM •

Name of Child Care Center: North Hudson Community Head Start		License ID: 09NOR0003
Site Address (Building # and Street): 5800 Kennedy Blvd.		
Municipality: West New York	County: Hudson	
Sponsor/Sponsor Representative: Jay Johnson		Phone #: (201) 428-4278
Sponsor/Sponsor Representative Email: jjohnson@nhcac.org		
Additional Contact Person: Furcy Tejada		Phone #: (201) 617-0901
Title: Facility Assistant	Email: ftejada@nhcac.org	

1. The center, as described above, has reviewed the MANUAL OF REQUIREMENTS FOR CHILD CARE CENTERS requiring testing for lead and copper in drinking water and provides assurance that the development and implementation of a testing program was completed in accordance with N.J.A.C. 3A:52-5.3(i)5i as evidenced by our completion of the attached Drinking Water Testing Checklist.
2. The center, as described above, provided all notifications of test results consistent with the requirements of this subchapter.
3. The center, as described above, will continue to fully implement the requirements of this subchapter, including the continuance of any actions taken in response to a lead or copper action level exceedance (e.g., continue to provide bottled water and/or maintain any remedial measure or treatment unit).

CERTIFICATION: By signing below, the **Sponsor or Sponsor Representative** certifies that all statements above are true and accurate:

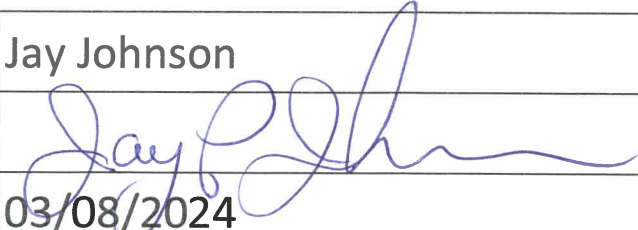
Sponsor/Sponsor Representative: (PRINT)	Jay Johnson
Signature:	
Signature Date:	03/08/2024



Monday, February 26, 2024

G. Luke Schroeder
Lead Consulting & Inspection, Inc.
219 Main St. P.O. Box 814
Chatham, NJ 07928

Project ID: NORTH HUDSON COMMUNITY
SDG ID: GCQ10190
Sample ID#s: CQ10190 - CQ10210

This laboratory is in compliance with the NELAC requirements of procedures used except where indicated.

This report contains results for the parameters tested, under the sampling conditions described on the Chain Of Custody, as received by the laboratory. This report is incomplete unless all pages indicated in the pagination at the bottom of the page are included.

A scanned version of the COC form accompanies the analytical report and is an exact duplicate of the original.

If you are the client above and have any questions concerning this testing, please do not hesitate to contact Phoenix Client Services at ext.200. The contents of this report cannot be discussed with anyone other than the client listed above without their written consent.

Sincerely yours,

A handwritten signature in black ink, appearing to read "Phyllis Shiller", is written over a horizontal line.

Phyllis Shiller

Laboratory Director

NELAC - #NY11301
CT Lab Registration #PH-0618
MA Lab Registration #M-CT007
ME Lab Registration #CT-007
NH Lab Registration #213693-A,B

NJ Lab Registration #CT-003
NY Lab Registration #11301
PA Lab Registration #68-03530
RI Lab Registration #63
VT Lab Registration #VT11301



Environmental Laboratories, Inc.
587 East Middle Turnpike, P.O.Box 370, Manchester, CT 06045
Tel. (860) 645-1102 Fax (860) 645-0823



Sample Id Cross Reference

February 26, 2024

SDG I.D.: GCQ10190

Project ID: NORTH HUDSON COMMUNITY

Client Id	Lab Id	Matrix
L/L/KIT/SINK	CQ10190	DRINKING WATER
L/LEV/LITCH/SINK	CQ10191	DRINKING WATER
L/L/KIT/SINK	CQ10192	DRINKING WATER
L/L/GIRLS/SINK #2	CQ10193	DRINKING WATER
L/L/BOYS/LEFT SINK	CQ10194	DRINKING WATER
L/L/BOYS/RIGHT SINK	CQ10195	DRINKING WATER
L/L/GR/SINK	CQ10196	DRINKING WATER
1ST FL/CR/RIGHT SINK	CQ10197	DRINKING WATER
1ST FL/CR/LEFT SINK	CQ10198	DRINKING WATER
1ST FL/CR/RIGHT SINK	CQ10199	DRINKING WATER
1ST FL/CR/LEFT SINK	CQ10200	DRINKING WATER
1ST FL/CR/RIGHT SINK	CQ10201	DRINKING WATER
1ST FL/CR/LEFT SINK	CQ10202	DRINKING WATER
1ST FL/CR/BATH SINK	CQ10203	DRINKING WATER
1ST FL/CR/SINK	CQ10204	DRINKING WATER
1ST FL/GIRLS/SINK	CQ10205	DRINKING WATER
1ST FL/BATH/SINK #2	CQ10206	DRINKING WATER
2ND FL/BATH/RIGHT SINK	CQ10207	DRINKING WATER
2ND FL/BATH/LEFT SINK	CQ10208	DRINKING WATER
2ND FL/BATH/RIGHT SINK	CQ10209	DRINKING WATER
2ND FL/BATH/LEFT SINK	CQ10210	DRINKING WATER



Environmental Laboratories, Inc.
587 East Middle Turnpike, P.O.Box 370, Manchester, CT 06045
Tel. (860) 645-1102 Fax (860) 645-0823



Analysis Report

February 26, 2024

FOR: G. Luke Schroeder
Lead Consulting & Inspection, Inc.
219 Main St. P.O. Box 814
Chatham, NJ 07928

Sample Information

Matrix: DRINKING WATER
Location Code: LEADCONSULT
Rush Request: Standard
P.O.#:

Custody Information

Collected by:
Received by: SW
Analyzed by: see "By" below

Date Time
01/23/24 7:18
02/20/24 10:55

Laboratory Data

SDG ID: GCQ10190
Phoenix ID: CQ10190

Project ID: NORTH HUDSON COMMUNITY
Client ID: L/L/KIT/SINK

Parameter	Result	RL/ PQL	DIL	Units	AL	MCL	MCLG	Date/Time	By	Reference
Copper	0.0086	0.0005	1	mg/L	1.3		1	02/22/24	TH	E200.7
Lead	< 0.0010	0.0010	1	mg/L	0.015			02/22/24	TH	E200.5
Total Metal Digestion	Completed							02/21/24	AG	E200.5/E200.7

RL/PQL=Reporting/Practical Quantitation Level DIL=Dilution (analysis required diluting to evaluate) ND=Not Detected
BRL=Below Reporting Level (less than the reporting level, the lowest amount the laboratory can detect and report.)
AL = Action Level MCL = Maximum Contaminant Level MCLG = Maximum Contaminant Level Goal

Comments:

Action Level (AL): 40 CFR Part 141.80 Lead & Copper ALs.

Secondary DW Maximum Contaminant Level Goal (MCLG): 40 CFR Part 143 Secondary Goals. The level of a contaminant in drinking water below which there is no known or expected risk to health. MCLGs are non-enforceable public health goals.

If you are the client above and have any questions concerning this testing, please do not hesitate to contact Phoenix Client Services at ext.200. The contents of this report cannot be discussed with anyone other than the client listed above without their written consent.

Phyllis Shiller, Laboratory Director

February 26, 2024

Reviewed and Released by: Anil Makol, Project Manager



Environmental Laboratories, Inc.
587 East Middle Turnpike, P.O.Box 370, Manchester, CT 06045
Tel. (860) 645-1102 Fax (860) 645-0823



Analysis Report

February 26, 2024

FOR: G. Luke Schroeder
Lead Consulting & Inspection, Inc.
219 Main St. P.O. Box 814
Chatham, NJ 07928

Sample Information

Matrix: DRINKING WATER
Location Code: LEADCONSULT
Rush Request: Standard
P.O.#:

Custody Information

Collected by:
Received by: SW
Analyzed by: see "By" below

Date Time

01/23/24 7:19
02/20/24 10:55

Laboratory Data

SDG ID: GCQ10190
Phoenix ID: CQ10191

Project ID: NORTH HUDSON COMMUNITY
Client ID: L/LEV/LITCH/SINK

Parameter	Result	RL/ PQL	DIL	Units	AL	MCL	MCLG	Date/Time	By	Reference
Copper	0.0610	0.0005	1	mg/L	1.3		1	02/22/24	TH	E200.7
Lead	< 0.001	0.001	1	mg/L	0.015			02/22/24	TH	E200.5
Total Metal Digestion	Completed							02/21/24	AG	E200.5/E200.7

RL/PQL=Reporting/Practical Quantitation Level DIL=Dilution (analysis required diluting to evaluate) ND=Not Detected
BRL=Below Reporting Level (less than the reporting level, the lowest amount the laboratory can detect and report.)
AL = Action Level MCL = Maximum Contaminant Level MCLG = Maximum Contaminant Level Goal

Comments:

Action Level (AL): 40 CFR Part 141.80 Lead & Copper ALs.

Secondary DW Maximum Contaminant Level Goal (MCLG): 40 CFR Part 143 Secondary Goals. The level of a contaminant in drinking water below which there is no known or expected risk to health. MCLGs are non-enforceable public health goals.

If you are the client above and have any questions concerning this testing, please do not hesitate to contact Phoenix Client Services at ext.200. The contents of this report cannot be discussed with anyone other than the client listed above without their written consent.

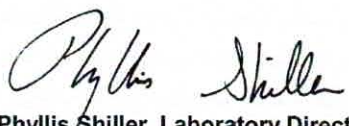
Phyllis Shiller, Laboratory Director

February 26, 2024

Reviewed and Released by: Anil Makol, Project Manager



Environmental Laboratories, Inc.
587 East Middle Turnpike, P.O.Box 370, Manchester, CT 06045
Tel. (860) 645-1102 Fax (860) 645-0823



Analysis Report

February 26, 2024

FOR: G. Luke Schroeder
Lead Consulting & Inspection, Inc.
219 Main St. P.O. Box 814
Chatham, NJ 07928

Sample Information

Matrix: DRINKING WATER
Location Code: LEADCONSULT
Rush Request: Standard
P.O.#:

Custody Information

Collected by:
Received by: SW
Analyzed by: see "By" below

Date Time
01/23/24 7:17
02/20/24 10:55

Laboratory Data

SDG ID: GCQ10190
Phoenix ID: CQ10192

Project ID: NORTH HUDSON COMMUNITY
Client ID: L/L/KIT/SINK

Parameter	Result	RL/ PQL	DIL	Units	AL	MCL	MCLG	Date/Time	By	Reference
Copper	0.0052	0.0005	1	mg/L	1.3		1	02/22/24	TH	E200.7
Lead	< 0.001	0.001	1	mg/L	0.015			02/22/24	TH	E200.5
Total Metal Digestion	Completed							02/21/24	AG	E200.5/E200.7

RL/PQL=Reporting/Practical Quantitation Level DIL=Dilution (analysis required diluting to evaluate) ND=Not Detected
BRL=Below Reporting Level (less than the reporting level, the lowest amount the laboratory can detect and report.)
AL = Action Level MCL = Maximum Contaminant Level MCLG = Maximum Contaminant Level Goal

Comments:

Action Level (AL): 40 CFR Part 141.80 Lead & Copper ALs.

Secondary DW Maximum Contaminant Level Goal (MCLG): 40 CFR Part 143 Secondary Goals. The level of a contaminant in drinking water below which there is no known or expected risk to health. MCLGs are non-enforceable public health goals.

If you are the client above and have any questions concerning this testing, please do not hesitate to contact Phoenix Client Services at ext.200. The contents of this report cannot be discussed with anyone other than the client listed above without their written consent.

Phyllis Shiller, Laboratory Director

February 26, 2024

Reviewed and Released by: Anil Makol, Project Manager



Environmental Laboratories, Inc.
587 East Middle Turnpike, P.O.Box 370, Manchester, CT 06045
Tel. (860) 645-1102 Fax (860) 645-0823



Analysis Report

February 26, 2024

FOR: G. Luke Schroeder
Lead Consulting & Inspection, Inc.
219 Main St. P.O. Box 814
Chatham, NJ 07928

Sample Information

Matrix: DRINKING WATER
Location Code: LEADCONSULT
Rush Request: Standard
P.O.#:

Custody Information

Collected by:
Received by: SW
Analyzed by: see "By" below

Date Time
01/23/24 7:23
02/20/24 10:55

Laboratory Data

SDG ID: GCQ10190
Phoenix ID: CQ10193

Project ID: NORTH HUDSON COMMUNITY
Client ID: L/L/GIRLS/SINK #2

Parameter	Result	RL/ PQL	DIL	Units	AL	MCL	MCLG	Date/Time	By	Reference
Copper	0.0248	0.0005	1	mg/L	1.3		1	02/22/24	TH	E200.7
Lead	< 0.001	0.001	1	mg/L	0.015			02/22/24	TH	E200.5
Total Metal Digestion	Completed							02/21/24	AG	E200.5/E200.7

RL/PQL=Reporting/Practical Quantitation Level DIL=Dilution (analysis required diluting to evaluate) ND=Not Detected
BRL=Below Reporting Level (less than the reporting level, the lowest amount the laboratory can detect and report.)
AL = Action Level MCL = Maximum Contaminant Level MCLG = Maximum Contaminant Level Goal

Comments:

Action Level (AL): 40 CFR Part 141.80 Lead & Copper ALs.

Secondary DW Maximum Contaminant Level Goal (MCLG): 40 CFR Part 143 Secondary Goals. The level of a contaminant in drinking water below which there is no known or expected risk to health. MCLGs are non-enforceable public health goals.

If you are the client above and have any questions concerning this testing, please do not hesitate to contact Phoenix Client Services at ext.200. The contents of this report cannot be discussed with anyone other than the client listed above without their written consent.

Phyllis Shiller, Laboratory Director

February 26, 2024

Reviewed and Released by: Anil Makol, Project Manager



Environmental Laboratories, Inc.
587 East Middle Turnpike, P.O.Box 370, Manchester, CT 06045
Tel. (860) 645-1102 Fax (860) 645-0823



Analysis Report

February 26, 2024

FOR: G. Luke Schroeder
Lead Consulting & Inspection, Inc.
219 Main St. P.O. Box 814
Chatham, NJ 07928

Sample Information

Matrix: DRINKING WATER
Location Code: LEADCONSULT
Rush Request: Standard
P.O.#:

Custody Information

Collected by:
Received by: SW
Analyzed by: see "By" below

Date Time
01/23/24 7:25
02/20/24 10:55

Laboratory Data

SDG ID: GCQ10190
Phoenix ID: CQ10194

Project ID: NORTH HUDSON COMMUNITY
Client ID: L/L/BOYS/LEFT SINK

Parameter	Result	RL/ PQL	DIL	Units	AL	MCL	MCLG	Date/Time	By	Reference
Copper	0.0765	0.0005	1	mg/L	1.3		1	02/22/24	TH	E200.7
Lead	< 0.001	0.001	1	mg/L	0.015			02/22/24	TH	E200.5
Total Metal Digestion	Completed							02/21/24	AG	E200.5/E200.7

RL/PQL=Reporting/Practical Quantitation Level DIL=Dilution (analysis required diluting to evaluate) ND=Not Detected
BRL=Below Reporting Level (less than the reporting level, the lowest amount the laboratory can detect and report.)
AL = Action Level MCL = Maximum Contaminant Level MCLG = Maximum Contaminant Level Goal

Comments:

Action Level (AL): 40 CFR Part 141.80 Lead & Copper ALs.

Secondary DW Maximum Contaminant Level Goal (MCLG): 40 CFR Part 143 Secondary Goals. The level of a contaminant in drinking water below which there is no known or expected risk to health. MCLGs are non-enforceable public health goals.

If you are the client above and have any questions concerning this testing, please do not hesitate to contact Phoenix Client Services at ext.200. The contents of this report cannot be discussed with anyone other than the client listed above without their written consent.

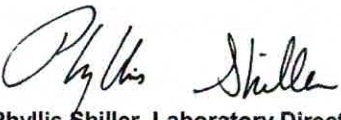
Phyllis Shiller, Laboratory Director

February 26, 2024

Reviewed and Released by: Anil Makol, Project Manager



Environmental Laboratories, Inc.
587 East Middle Turnpike, P.O.Box 370, Manchester, CT 06045
Tel. (860) 645-1102 Fax (860) 645-0823



Analysis Report

February 26, 2024

FOR: G. Luke Schroeder
Lead Consulting & Inspection, Inc.
219 Main St. P.O. Box 814
Chatham, NJ 07928

Sample Information

Matrix: DRINKING WATER
Location Code: LEADCONSULT
Rush Request: Standard
P.O.#:

Custody Information

Collected by:
Received by: SW
Analyzed by: see "By" below

Date

01/23/24
02/20/24

Time

7:26
10:55

Laboratory Data

SDG ID: GCQ10190
Phoenix ID: CQ10195

Project ID: NORTH HUDSON COMMUNITY
Client ID: L/L/BOYS/RIGHT SINK

Parameter	Result	RL/ PQL	DIL	Units	AL	MCL	MCLG	Date/Time	By	Reference
Copper	0.0245	0.0005	1	mg/L	1.3		1	02/22/24	TH	E200.7
Lead	< 0.001	0.001	1	mg/L	0.015			02/22/24	TH	E200.5
Total Metal Digestion	Completed							02/21/24	AG	E200.5/E200.7

RL/PQL=Reporting/Practical Quantitation Level DIL=Dilution (analysis required diluting to evaluate) ND=Not Detected
BRL=Below Reporting Level (less than the reporting level, the lowest amount the laboratory can detect and report.)
AL = Action Level MCL = Maximum Contaminant Level MCLG = Maximum Contaminant Level Goal

Comments:

Action Level (AL): 40 CFR Part 141.80 Lead & Copper ALs.

Secondary DW Maximum Contaminant Level Goal (MCLG): 40 CFR Part 143 Secondary Goals. The level of a contaminant in drinking water below which there is no known or expected risk to health. MCLGs are non-enforceable public health goals.

If you are the client above and have any questions concerning this testing, please do not hesitate to contact Phoenix Client Services at ext.200. The contents of this report cannot be discussed with anyone other than the client listed above without their written consent.

Phyllis Shiller, Laboratory Director

February 26, 2024

Reviewed and Released by: Anil Makol, Project Manager



Environmental Laboratories, Inc.
587 East Middle Turnpike, P.O.Box 370, Manchester, CT 06045
Tel. (860) 645-1102 Fax (860) 645-0823



Analysis Report

February 26, 2024

FOR: G. Luke Schroeder
Lead Consulting & Inspection, Inc.
219 Main St. P.O. Box 814
Chatham, NJ 07928

Sample Information

Matrix: DRINKING WATER
Location Code: LEADCONSULT
Rush Request: Standard
P.O.#:

Custody Information

Collected by:
Received by: SW
Analyzed by: see "By" below

Date Time
01/23/24 7:32
02/20/24 10:55

Laboratory Data

SDG ID: GCQ10190
Phoenix ID: CQ10196

Project ID: NORTH HUDSON COMMUNITY
Client ID: L/L/GR/SINK

Parameter	Result	RL/ PQL	DIL	Units	AL	MCL	MCLG	Date/Time	By	Reference
Copper	0.250	0.0005	1	mg/L	1.3		1	02/22/24	TH	E200.7
Lead	< 0.001	0.001	1	mg/L	0.015			02/22/24	TH	E200.5
Total Metal Digestion	Completed							02/21/24	AG	E200.5/E200.7

RL/PQL=Reporting/Practical Quantitation Level DIL=Dilution (analysis required diluting to evaluate) ND=Not Detected
BRL=Below Reporting Level (less than the reporting level, the lowest amount the laboratory can detect and report.)
AL = Action Level MCL = Maximum Contaminant Level MCLG = Maximum Contaminant Level Goal

Comments:

Action Level (AL): 40 CFR Part 141.80 Lead & Copper ALs.

Secondary DW Maximum Contaminant Level Goal (MCLG): 40 CFR Part 143 Secondary Goals. The level of a contaminant in drinking water below which there is no known or expected risk to health. MCLGs are non-enforceable public health goals.

If you are the client above and have any questions concerning this testing, please do not hesitate to contact Phoenix Client Services at ext.200. The contents of this report cannot be discussed with anyone other than the client listed above without their written consent.

Phyllis Shiller, Laboratory Director

February 26, 2024

Reviewed and Released by: Anil Makol, Project Manager



Environmental Laboratories, Inc.
587 East Middle Turnpike, P.O.Box 370, Manchester, CT 06045
Tel. (860) 645-1102 Fax (860) 645-0823



Analysis Report

February 26, 2024

FOR: G. Luke Schroeder
Lead Consulting & Inspection, Inc.
219 Main St. P.O. Box 814
Chatham, NJ 07928

Sample Information

Matrix: DRINKING WATER
Location Code: LEADCONSULT
Rush Request: Standard
P.O.#:

Custody Information

Collected by:
Received by: SW
Analyzed by: see "By" below

Date Time

01/23/24 7:35
02/20/24 10:55

Laboratory Data

SDG ID: GCQ10190
Phoenix ID: CQ10197

Project ID: NORTH HUDSON COMMUNITY
Client ID: 1ST FL/CR/RIGHT SINK

Parameter	Result	RL/ PQL	DIL	Units	AL	MCL	MCLG	Date/Time	By	Reference
Copper	0.0197	0.0005	1	mg/L	1.3		1	02/22/24	TH	E200.7
Lead	< 0.001	0.001	1	mg/L	0.015			02/22/24	TH	E200.5
Total Metal Digestion	Completed							02/21/24	AG	E200.5/E200.7

RL/PQL=Reporting/Practical Quantitation Level DIL=Dilution (analysis required diluting to evaluate) ND=Not Detected
BRL=Below Reporting Level (less than the reporting level, the lowest amount the laboratory can detect and report.)
AL = Action Level MCL = Maximum Contaminant Level MCLG = Maximum Contaminant Level Goal

Comments:

Action Level (AL): 40 CFR Part 141.80 Lead & Copper ALs.

Secondary DW Maximum Contaminant Level Goal (MCLG): 40 CFR Part 143 Secondary Goals. The level of a contaminant in drinking water below which there is no known or expected risk to health. MCLGs are non-enforceable public health goals.

If you are the client above and have any questions concerning this testing, please do not hesitate to contact Phoenix Client Services at ext.200. The contents of this report cannot be discussed with anyone other than the client listed above without their written consent.

Phyllis Shiller, Laboratory Director

February 26, 2024

Reviewed and Released by: Anil Makol, Project Manager



Environmental Laboratories, Inc.
587 East Middle Turnpike, P.O.Box 370, Manchester, CT 06045
Tel. (860) 645-1102 Fax (860) 645-0823



Analysis Report

February 26, 2024

FOR: G. Luke Schroeder
Lead Consulting & Inspection, Inc.
219 Main St. P.O. Box 814
Chatham, NJ 07928

Sample Information

Matrix: DRINKING WATER
Location Code: LEADCONSULT
Rush Request: Standard
P.O.#:

Custody Information

Collected by:
Received by: SW
Analyzed by: see "By" below

Date Time
01/23/24 7:36
02/20/24 10:55

Laboratory Data

SDG ID: GCQ10190
Phoenix ID: CQ10198

Project ID: NORTH HUDSON COMMUNITY
Client ID: 1ST FL/CR/LEFT SINK

Parameter	Result	RL/ PQL	DIL	Units	AL	MCL	MCLG	Date/Time	By	Reference
Copper	0.0045	0.0005	1	mg/L	1.3		1	02/22/24	TH	E200.7
Lead	< 0.001	0.001	1	mg/L	0.015			02/22/24	TH	E200.5
Total Metal Digestion	Completed							02/21/24	AG	E200.5/E200.7

RL/PQL=Reporting/Practical Quantitation Level DIL=Dilution (analysis required diluting to evaluate) ND=Not Detected
BRL=Below Reporting Level (less than the reporting level, the lowest amount the laboratory can detect and report.)
AL = Action Level MCL = Maximum Contaminant Level MCLG = Maximum Contaminant Level Goal

Comments:

Action Level (AL): 40 CFR Part 141.80 Lead & Copper ALs.

Secondary DW Maximum Contaminant Level Goal (MCLG): 40 CFR Part 143 Secondary Goals. The level of a contaminant in drinking water below which there is no known or expected risk to health. MCLGs are non-enforceable public health goals.

If you are the client above and have any questions concerning this testing, please do not hesitate to contact Phoenix Client Services at ext.200. The contents of this report cannot be discussed with anyone other than the client listed above without their written consent.

Phyllis Shiller, Laboratory Director

February 26, 2024

Reviewed and Released by: Anil Makol, Project Manager



Environmental Laboratories, Inc.
587 East Middle Turnpike, P.O.Box 370, Manchester, CT 06045
Tel. (860) 645-1102 Fax (860) 645-0823



Analysis Report

February 26, 2024

FOR: G. Luke Schroeder
Lead Consulting & Inspection, Inc.
219 Main St. P.O. Box 814
Chatham, NJ 07928

Sample Information

Matrix: DRINKING WATER
Location Code: LEADCONSULT
Rush Request: Standard
P.O.#:

Custody Information

Collected by:
Received by: SW
Analyzed by: see "By" below

Date Time
01/23/24 7:38
02/20/24 10:55

Laboratory Data

SDG ID: GCQ10190
Phoenix ID: CQ10199

Project ID: NORTH HUDSON COMMUNITY
Client ID: 1ST FL/CR/RIGHT SINK

Parameter	Result	RL/ PQL	DIL	Units	AL	MCL	MCLG	Date/Time	By	Reference
Copper	0.0664	0.0005	1	mg/L	1.3		1	02/22/24	TH	E200.7
Lead	< 0.001	0.001	1	mg/L	0.015			02/22/24	TH	E200.5
Total Metal Digestion	Completed							02/21/24	AG	E200.5/E200.7

RL/PQL=Reporting/Practical Quantitation Level DIL=Dilution (analysis required diluting to evaluate) ND=Not Detected
BRL=Below Reporting Level (less than the reporting level, the lowest amount the laboratory can detect and report.)
AL = Action Level MCL = Maximum Contaminant Level MCLG = Maximum Contaminant Level Goal

Comments:

Action Level (AL): 40 CFR Part 141.80 Lead & Copper ALs.

Secondary DW Maximum Contaminant Level Goal (MCLG): 40 CFR Part 143 Secondary Goals. The level of a contaminant in drinking water below which there is no known or expected risk to health. MCLGs are non-enforceable public health goals.

If you are the client above and have any questions concerning this testing, please do not hesitate to contact Phoenix Client Services at ext.200. The contents of this report cannot be discussed with anyone other than the client listed above without their written consent.

Phyllis Shiller, Laboratory Director

February 26, 2024

Reviewed and Released by: Anil Makol, Project Manager



Environmental Laboratories, Inc.
587 East Middle Turnpike, P.O.Box 370, Manchester, CT 06045
Tel. (860) 645-1102 Fax (860) 645-0823



Analysis Report

February 26, 2024

FOR: G. Luke Schroeder
Lead Consulting & Inspection, Inc.
219 Main St. P.O. Box 814
Chatham, NJ 07928

Sample Information

Matrix: DRINKING WATER
Location Code: LEADCONSULT
Rush Request: Standard
P.O.#:

Custody Information

Collected by:
Received by: SW
Analyzed by: see "By" below

Date Time
01/23/24 7:40
02/20/24 10:55

Laboratory Data

SDG ID: GCQ10190
Phoenix ID: CQ10200

Project ID: NORTH HUDSON COMMUNITY
Client ID: 1ST FL/CR/LEFT SINK

Parameter	Result	RL/ PQL	DIL	Units	AL	MCL	MCLG	Date/Time	By	Reference
Copper	0.175	0.0005	1	mg/L	1.3		1	02/22/24	TH	E200.7
Lead	< 0.001	0.001	1	mg/L	0.015			02/22/24	TH	E200.5
Total Metal Digestion	Completed							02/21/24	AG	E200.5/E200.7

RL/PQL=Reporting/Practical Quantitation Level DIL=Dilution (analysis required diluting to evaluate) ND=Not Detected
BRL=Below Reporting Level (less than the reporting level, the lowest amount the laboratory can detect and report.)
AL = Action Level MCL = Maximum Contaminant Level MCLG = Maximum Contaminant Level Goal

Comments:

Action Level (AL): 40 CFR Part 141.80 Lead & Copper ALs.

Secondary DW Maximum Contaminant Level Goal (MCLG): 40 CFR Part 143 Secondary Goals. The level of a contaminant in drinking water below which there is no known or expected risk to health. MCLGs are non-enforceable public health goals.

If you are the client above and have any questions concerning this testing, please do not hesitate to contact Phoenix Client Services at ext.200. The contents of this report cannot be discussed with anyone other than the client listed above without their written consent.

Phyllis Shiller, Laboratory Director

February 26, 2024

Reviewed and Released by: Anil Makol, Project Manager



Environmental Laboratories, Inc.
587 East Middle Turnpike, P.O.Box 370, Manchester, CT 06045
Tel. (860) 645-1102 Fax (860) 645-0823



Analysis Report

February 26, 2024

FOR: G. Luke Schroeder
Lead Consulting & Inspection, Inc.
219 Main St. P.O. Box 814
Chatham, NJ 07928

Sample Information

Matrix: DRINKING WATER
Location Code: LEADCONSULT
Rush Request: Standard
P.O.#:

Custody Information

Collected by:
Received by: SW
Analyzed by: see "By" below

Date Time

01/23/24 7:43
02/20/24 10:55

Laboratory Data

SDG ID: GCQ10190
Phoenix ID: CQ10201

Project ID: NORTH HUDSON COMMUNITY
Client ID: 1ST FL/CR/RIGHT SINK

Parameter	Result	RL/ PQL	DIL	Units	AL	MCL	MCLG	Date/Time	By	Reference
Copper	0.0164	0.0005	1	mg/L	1.3		1	02/22/24	TH	E200.7
Lead	< 0.001	0.001	1	mg/L	0.015			02/22/24	TH	E200.5
Total Metal Digestion	Completed							02/21/24	AG	E200.5/E200.7

RL/PQL=Reporting/Practical Quantitation Level DIL=Dilution (analysis required diluting to evaluate) ND=Not Detected
BRL=Below Reporting Level (less than the reporting level, the lowest amount the laboratory can detect and report.)
AL = Action Level MCL = Maximum Contaminant Level MCLG = Maximum Contaminant Level Goal

Comments:

Action Level (AL): 40 CFR Part 141.80 Lead & Copper ALs.

Secondary DW Maximum Contaminant Level Goal (MCLG): 40 CFR Part 143 Secondary Goals. The level of a contaminant in drinking water below which there is no known or expected risk to health. MCLGs are non-enforceable public health goals.

If you are the client above and have any questions concerning this testing, please do not hesitate to contact Phoenix Client Services at ext.200. The contents of this report cannot be discussed with anyone other than the client listed above without their written consent.

Phyllis Shiller, Laboratory Director

February 26, 2024

Reviewed and Released by: Anil Makol, Project Manager



Environmental Laboratories, Inc.
587 East Middle Turnpike, P.O.Box 370, Manchester, CT 06045
Tel. (860) 645-1102 Fax (860) 645-0823



Analysis Report

February 26, 2024

FOR: G. Luke Schroeder
Lead Consulting & Inspection, Inc.
219 Main St. P.O. Box 814
Chatham, NJ 07928

Sample Information

Matrix: DRINKING WATER
Location Code: LEADCONSULT
Rush Request: Standard
P.O.#:

Custody Information

Collected by:
Received by: SW
Analyzed by: see "By" below

Date Time

01/23/24 7:44
02/20/24 10:55

Laboratory Data

SDG ID: GCQ10190
Phoenix ID: CQ10202

Project ID: NORTH HUDSON COMMUNITY
Client ID: 1ST FL/CR/LEFT SINK

Parameter	Result	RL/ PQL	DIL	Units	AL	MCL	MCLG	Date/Time	By	Reference
Copper	0.0077	0.0005	1	mg/L	1.3		1	02/22/24	TH	E200.7
Lead	< 0.001	0.001	1	mg/L	0.015			02/22/24	TH	E200.5
Total Metal Digestion	Completed							02/21/24	AG	E200.5/E200.7

RL/PQL=Reporting/Practical Quantitation Level DIL=Dilution (analysis required diluting to evaluate) ND=Not Detected
BRL=Below Reporting Level (less than the reporting level, the lowest amount the laboratory can detect and report.)
AL = Action Level MCL = Maximum Contaminant Level MCLG = Maximum Contaminant Level Goal

Comments:

Action Level (AL): 40 CFR Part 141.80 Lead & Copper ALs.

Secondary DW Maximum Contaminant Level Goal (MCLG): 40 CFR Part 143 Secondary Goals. The level of a contaminant in drinking water below which there is no known or expected risk to health. MCLGs are non-enforceable public health goals.

If you are the client above and have any questions concerning this testing, please do not hesitate to contact Phoenix Client Services at ext.200. The contents of this report cannot be discussed with anyone other than the client listed above without their written consent.

Phyllis Shiller, Laboratory Director

February 26, 2024

Reviewed and Released by: Anil Makol, Project Manager



Environmental Laboratories, Inc.
587 East Middle Turnpike, P.O.Box 370, Manchester, CT 06045
Tel. (860) 645-1102 Fax (860) 645-0823



Analysis Report

February 26, 2024

FOR: G. Luke Schroeder
Lead Consulting & Inspection, Inc.
219 Main St. P.O. Box 814
Chatham, NJ 07928

Sample Information

Matrix: DRINKING WATER
Location Code: LEADCONSULT
Rush Request: Standard
P.O.#:

Custody Information

Collected by:
Received by: SW
Analyzed by: see "By" below

Date Time
01/23/24 7:45
02/20/24 10:55

Laboratory Data

SDG ID: GCQ10190
Phoenix ID: CQ10203

Project ID: NORTH HUDSON COMMUNITY
Client ID: 1ST FL/CR/BATH SINK

Parameter	Result	RL/ PQL	DIL	Units	AL	MCL	MCLG	Date/Time	By	Reference
Copper	0.0280	0.0005	1	mg/L	1.3		1	02/22/24	TH	E200.7
Lead	< 0.001	0.001	1	mg/L	0.015			02/22/24	TH	E200.5
Total Metal Digestion	Completed							02/21/24	AG	E200.5/E200.7

RL/PQL=Reporting/Practical Quantitation Level DIL=Dilution (analysis required diluting to evaluate) ND=Not Detected
BRL=Below Reporting Level (less than the reporting level, the lowest amount the laboratory can detect and report.)
AL = Action Level MCL = Maximum Contaminant Level MCLG = Maximum Contaminant Level Goal

Comments:

Action Level (AL): 40 CFR Part 141.80 Lead & Copper ALs.

Secondary DW Maximum Contaminant Level Goal (MCLG): 40 CFR Part 143 Secondary Goals. The level of a contaminant in drinking water below which there is no known or expected risk to health. MCLGs are non-enforceable public health goals.

If you are the client above and have any questions concerning this testing, please do not hesitate to contact Phoenix Client Services at ext.200. The contents of this report cannot be discussed with anyone other than the client listed above without their written consent.

Phyllis Shiller, Laboratory Director

February 26, 2024

Reviewed and Released by: Anil Makol, Project Manager



Environmental Laboratories, Inc.
587 East Middle Turnpike, P.O.Box 370, Manchester, CT 06045
Tel. (860) 645-1102 Fax (860) 645-0823



Analysis Report

February 26, 2024

FOR: G. Luke Schroeder
Lead Consulting & Inspection, Inc.
219 Main St. P.O. Box 814
Chatham, NJ 07928

Sample Information

Matrix: DRINKING WATER
Location Code: LEADCONSULT
Rush Request: Standard
P.O.#:

Custody Information

Collected by:
Received by: SW
Analyzed by: see "By" below

Date

01/23/24 7:50
02/20/24 10:55

Laboratory Data

SDG ID: GCQ10190
Phoenix ID: CQ10204

Project ID: NORTH HUDSON COMMUNITY
Client ID: 1ST FL/CR/SINK

Parameter	Result	RL/ PQL	DIL	Units	AL	MCL	MCLG	Date/Time	By	Reference
Copper	0.311	0.0005	1	mg/L	1.3		1	02/22/24	TH	E200.7
Lead	< 0.001	0.001	1	mg/L	0.015			02/22/24	TH	E200.5
Total Metal Digestion	Completed							02/21/24	AG	E200.5/E200.7

RL/PQL=Reporting/Practical Quantitation Level DIL=Dilution (analysis required diluting to evaluate) ND=Not Detected
BRL=Below Reporting Level (less than the reporting level, the lowest amount the laboratory can detect and report.)
AL = Action Level MCL = Maximum Contaminant Level MCLG = Maximum Contaminant Level Goal

Comments:

Action Level (AL): 40 CFR Part 141.80 Lead & Copper ALs.

Secondary DW Maximum Contaminant Level Goal (MCLG): 40 CFR Part 143 Secondary Goals. The level of a contaminant in drinking water below which there is no known or expected risk to health. MCLGs are non-enforceable public health goals.

If you are the client above and have any questions concerning this testing, please do not hesitate to contact Phoenix Client Services at ext.200. The contents of this report cannot be discussed with anyone other than the client listed above without their written consent.

Phyllis Shiller, Laboratory Director

February 26, 2024

Reviewed and Released by: Anil Makol, Project Manager



Environmental Laboratories, Inc.
587 East Middle Turnpike, P.O.Box 370, Manchester, CT 06045
Tel. (860) 645-1102 Fax (860) 645-0823



Analysis Report

February 26, 2024

FOR: G. Luke Schroeder
Lead Consulting & Inspection, Inc.
219 Main St. P.O. Box 814
Chatham, NJ 07928

Sample Information

Matrix: DRINKING WATER
Location Code: LEADCONSULT
Rush Request: Standard
P.O.#:

Custody Information

Collected by:
Received by: SW
Analyzed by: see "By" below

Date Time
01/23/24 7:52
02/20/24 10:55

Laboratory Data

SDG ID: GCQ10190
Phoenix ID: CQ10205

Project ID: NORTH HUDSON COMMUNITY
Client ID: 1ST FL/GIRLS/SINK

Parameter	Result	RL/ PQL	DIL	Units	AL	MCL	MCLG	Date/Time	By	Reference
Copper	0.0333	0.0005	1	mg/L	1.3		1	02/22/24	TH	E200.7
Lead	< 0.001	0.001	1	mg/L	0.015			02/22/24	TH	E200.5
Total Metal Digestion	Completed							02/21/24	AG	E200.5/E200.7

RL/PQL=Reporting/Practical Quantitation Level DIL=Dilution (analysis required diluting to evaluate) ND=Not Detected
BRL=Below Reporting Level (less than the reporting level, the lowest amount the laboratory can detect and report.)
AL = Action Level MCL = Maximum Contaminant Level MCLG = Maximum Contaminant Level Goal

Comments:

Action Level (AL): 40 CFR Part 141.80 Lead & Copper ALs.

Secondary DW Maximum Contaminant Level Goal (MCLG): 40 CFR Part 143 Secondary Goals. The level of a contaminant in drinking water below which there is no known or expected risk to health. MCLGs are non-enforceable public health goals.

If you are the client above and have any questions concerning this testing, please do not hesitate to contact Phoenix Client Services at ext.200. The contents of this report cannot be discussed with anyone other than the client listed above without their written consent.

Phyllis Shiller, Laboratory Director

February 26, 2024

Reviewed and Released by: Anil Makol, Project Manager



Environmental Laboratories, Inc.
587 East Middle Turnpike, P.O.Box 370, Manchester, CT 06045
Tel. (860) 645-1102 Fax (860) 645-0823



Analysis Report

February 26, 2024

FOR: G. Luke Schroeder
Lead Consulting & Inspection, Inc.
219 Main St. P.O. Box 814
Chatham, NJ 07928

Sample Information

Matrix: DRINKING WATER
Location Code: LEADCONSULT
Rush Request: Standard
P.O.#:

Custody Information

Collected by:
Received by: SW
Analyzed by: see "By" below

Date Time

01/23/24 7:55
02/20/24 10:55

Laboratory Data

SDG ID: GCQ10190
Phoenix ID: CQ10206

Project ID: NORTH HUDSON COMMUNITY
Client ID: 1ST FL/BATH/SINK #2

Parameter	Result	RL/ PQL	DIL	Units	AL	MCL	MCLG	Date/Time	By	Reference
Copper	0.0287	0.0005	1	mg/L	1.3		1	02/22/24	TH	E200.7
Lead	< 0.001	0.001	1	mg/L	0.015			02/22/24	TH	E200.5
Total Metal Digestion	Completed							02/21/24	AG	E200.5/E200.7

RL/PQL=Reporting/Practical Quantitation Level DIL=Dilution (analysis required diluting to evaluate) ND=Not Detected
BRL=Below Reporting Level (less than the reporting level, the lowest amount the laboratory can detect and report.)
AL = Action Level MCL = Maximum Contaminant Level MCLG = Maximum Contaminant Level Goal

Comments:

Action Level (AL): 40 CFR Part 141.80 Lead & Copper ALs.

Secondary DW Maximum Contaminant Level Goal (MCLG): 40 CFR Part 143 Secondary Goals. The level of a contaminant in drinking water below which there is no known or expected risk to health. MCLGs are non-enforceable public health goals.

If you are the client above and have any questions concerning this testing, please do not hesitate to contact Phoenix Client Services at ext.200. The contents of this report cannot be discussed with anyone other than the client listed above without their written consent.

Phyllis Shiller, Laboratory Director

February 26, 2024

Reviewed and Released by: Anil Makol, Project Manager



Environmental Laboratories, Inc.
587 East Middle Turnpike, P.O.Box 370, Manchester, CT 06045
Tel. (860) 645-1102 Fax (860) 645-0823



Analysis Report

February 26, 2024

FOR: G. Luke Schroeder
Lead Consulting & Inspection, Inc.
219 Main St. P.O. Box 814
Chatham, NJ 07928

Sample Information

Matrix: DRINKING WATER
Location Code: LEADCONSULT
Rush Request: Standard
P.O.#:

Custody Information

Collected by:
Received by: SW
Analyzed by: see "By" below

Date

01/23/24 8:05

Time

02/20/24 10:55

Laboratory Data

SDG ID: GCQ10190
Phoenix ID: CQ10207

Project ID: NORTH HUDSON COMMUNITY

Client ID: 2ND FL/BATH/RIGHT SINK

Parameter	Result	RL/ PQL	DIL	Units	AL	MCL	MCLG	Date/Time	By	Reference
Copper	0.0088	0.0005	1	mg/L	1.3		1	02/22/24	TH	E200.7
Lead	< 0.001	0.001	1	mg/L	0.015			02/22/24	TH	E200.5
Total Metal Digestion	Completed							02/21/24	AG	E200.5/E200.7

RL/PQL=Reporting/Practical Quantitation Level DIL=Dilution (analysis required diluting to evaluate) ND=Not Detected
BRL=Below Reporting Level (less than the reporting level, the lowest amount the laboratory can detect and report.)
AL = Action Level MCL = Maximum Contaminant Level MCLG = Maximum Contaminant Level Goal

Comments:

Action Level (AL): 40 CFR Part 141.80 Lead & Copper ALs.

Secondary DW Maximum Contaminant Level Goal (MCLG): 40 CFR Part 143 Secondary Goals. The level of a contaminant in drinking water below which there is no known or expected risk to health. MCLGs are non-enforceable public health goals.

If you are the client above and have any questions concerning this testing, please do not hesitate to contact Phoenix Client Services at ext.200. The contents of this report cannot be discussed with anyone other than the client listed above without their written consent.

Phyllis Shiller, Laboratory Director

February 26, 2024

Reviewed and Released by: Anil Makol, Project Manager



Environmental Laboratories, Inc.
587 East Middle Turnpike, P.O.Box 370, Manchester, CT 06045
Tel. (860) 645-1102 Fax (860) 645-0823



Analysis Report

February 26, 2024

FOR: G. Luke Schroeder
Lead Consulting & Inspection, Inc.
219 Main St. P.O. Box 814
Chatham, NJ 07928

Sample Information

Matrix: DRINKING WATER
Location Code: LEADCONSULT
Rush Request: Standard
P.O.#:

Custody Information

Collected by:
Received by: SW
Analyzed by: see "By" below

Date Time

01/23/24 8:07
02/20/24 10:55

Laboratory Data

SDG ID: GCQ10190
Phoenix ID: CQ10208

Project ID: NORTH HUDSON COMMUNITY
Client ID: 2ND FL/BATH/LEFT SINK

Parameter	Result	RL/ PQL	DIL	Units	AL	MCL	MCLG	Date/Time	By	Reference
Copper	0.0090	0.0005	1	mg/L	1.3		1	02/22/24	TH	E200.7
Lead	< 0.001	0.001	1	mg/L	0.015			02/22/24	TH	E200.5
Total Metal Digestion	Completed							02/21/24	AG	E200.5/E200.7

RL/PQL=Reporting/Practical Quantitation Level DIL=Dilution (analysis required diluting to evaluate) ND=Not Detected
BRL=Below Reporting Level (less than the reporting level, the lowest amount the laboratory can detect and report.)
AL = Action Level MCL = Maximum Contaminant Level MCLG = Maximum Contaminant Level Goal

Comments:

Action Level (AL): 40 CFR Part 141.80 Lead & Copper ALs.

Secondary DW Maximum Contaminant Level Goal (MCLG): 40 CFR Part 143 Secondary Goals. The level of a contaminant in drinking water below which there is no known or expected risk to health. MCLGs are non-enforceable public health goals.

If you are the client above and have any questions concerning this testing, please do not hesitate to contact Phoenix Client Services at ext.200. The contents of this report cannot be discussed with anyone other than the client listed above without their written consent.

Phyllis Shiller, Laboratory Director

February 26, 2024

Reviewed and Released by: Anil Makol, Project Manager



Environmental Laboratories, Inc.
587 East Middle Turnpike, P.O.Box 370, Manchester, CT 06045
Tel. (860) 645-1102 Fax (860) 645-0823



Analysis Report

February 26, 2024

FOR: G. Luke Schroeder
Lead Consulting & Inspection, Inc.
219 Main St. P.O. Box 814
Chatham, NJ 07928

Sample Information

Matrix: DRINKING WATER
Location Code: LEADCONSULT
Rush Request: Standard
P.O.#:

Custody Information

Collected by:
Received by: SW
Analyzed by: see "By" below

Date Time
01/23/24 8:15
02/20/24 10:55

Laboratory Data

SDG ID: GCQ10190
Phoenix ID: CQ10209

Project ID: NORTH HUDSON COMMUNITY
Client ID: 2ND FL/BATH/RIGHT SINK

Parameter	Result	RL/ PQL	DIL	Units	AL	MCL	MCLG	Date/Time	By	Reference
Copper	0.0125	0.0005	1	mg/L	1.3		1	02/22/24	TH	E200.7
Lead	< 0.001	0.001	1	mg/L	0.015			02/22/24	TH	E200.5
Total Metal Digestion	Completed							02/21/24	AG	E200.5/E200.7

RL/PQL=Reporting/Practical Quantitation Level DIL=Dilution (analysis required diluting to evaluate) ND=Not Detected
BRL=Below Reporting Level (less than the reporting level, the lowest amount the laboratory can detect and report.)
AL = Action Level MCL = Maximum Contaminant Level MCLG = Maximum Contaminant Level Goal

Comments:

Action Level (AL): 40 CFR Part 141.80 Lead & Copper ALs.

Secondary DW Maximum Contaminant Level Goal (MCLG): 40 CFR Part 143 Secondary Goals. The level of a contaminant in drinking water below which there is no known or expected risk to health. MCLGs are non-enforceable public health goals.

If you are the client above and have any questions concerning this testing, please do not hesitate to contact Phoenix Client Services at ext.200. The contents of this report cannot be discussed with anyone other than the client listed above without their written consent.

Phyllis Shiller, Laboratory Director

February 26, 2024

Reviewed and Released by: Anil Makol, Project Manager



Environmental Laboratories, Inc.
587 East Middle Turnpike, P.O.Box 370, Manchester, CT 06045
Tel. (860) 645-1102 Fax (860) 645-0823



Analysis Report

February 26, 2024

FOR: G. Luke Schroeder
Lead Consulting & Inspection, Inc.
219 Main St. P.O. Box 814
Chatham, NJ 07928

Sample Information

Matrix: DRINKING WATER
Location Code: LEADCONSULT
Rush Request: Standard
P.O.#:

Custody Information

Collected by:
Received by: SW
Analyzed by: see "By" below

Date Time

01/23/24 8:17
02/20/24 10:55

Laboratory Data

SDG ID: GCQ10190
Phoenix ID: CQ10210

Project ID: NORTH HUDSON COMMUNITY
Client ID: 2ND FL/BATH/LEFT SINK

Parameter	Result	RL/ PQL	DIL	Units	AL	MCL	MCLG	Date/Time	By	Reference
Copper	0.009	0.002	1	mg/L	1.3		1	02/23/24	TH	E200.7
Lead	< 0.0010	0.0010	1	mg/L	0.015			02/23/24	TH	E200.5
Total Metal Digestion	Completed							02/21/24	S/P/AG	E200.5/E200.7

RL/PQL=Reporting/Practical Quantitation Level DIL=Dilution (analysis required diluting to evaluate) ND=Not Detected
BRL=Below Reporting Level (less than the reporting level, the lowest amount the laboratory can detect and report.)
AL = Action Level MCL = Maximum Contaminant Level MCLG = Maximum Contaminant Level Goal

Comments:

Action Level (AL): 40 CFR Part 141.80 Lead & Copper ALs.

Secondary DW Maximum Contaminant Level Goal (MCLG): 40 CFR Part 143 Secondary Goals. The level of a contaminant in drinking water below which there is no known or expected risk to health. MCLGs are non-enforceable public health goals.

If you are the client above and have any questions concerning this testing, please do not hesitate to contact Phoenix Client Services at ext.200. The contents of this report cannot be discussed with anyone other than the client listed above without their written consent.

Phyllis Shiller, Laboratory Director

February 26, 2024

Reviewed and Released by: Anil Makol, Project Manager



Environmental Laboratories, Inc.
587 East Middle Turnpike, P.O.Box 370, Manchester, CT 06045
Tel. (860) 645-1102



QA/QC Report

February 26, 2024

QA/QC Data

SDG I.D.: GCQ10190

Parameter	Blank	Blk RL	Sample Result	Dup Result	Dup RPD	LCS %	LCSD %	LCS RPD	MS %	MSD %	MS RPD	% Rec Limits	% RPD Limits
-----------	-------	-----------	------------------	---------------	------------	----------	-----------	------------	---------	----------	-----------	--------------------	--------------------

QA/QC Batch 719144 (mg/L), QC Sample No: CQ10190 (CQ10190, CQ10191, CQ10192, CQ10193, CQ10194, CQ10195, CQ10196, CQ10197, CQ10198, CQ10199)

ICP Metals - Aqueous

Copper	BRL	0.0005	0.0086	0.0091	5.60	105			108			85 - 115	20
Lead	BRL	0.001	<0.0010	<0.0010	NC	104			106			85 - 115	20

Comment:

Additional: LCS acceptance range is 85-115% MS acceptance range 75-125%.

QA/QC Batch 719144A (mg/L), QC Sample No: CQ10200 (CQ10200, CQ10201, CQ10202, CQ10203, CQ10204, CQ10205, CQ10206, CQ10207, CQ10208, CQ10209)

ICP Metals - Aqueous

Copper	BRL	0.0005				105			109			85 - 115	20
Lead	BRL	0.001				104			106			85 - 115	20

Comment:

This batch does not include a duplicate.

Additional: LCS acceptance range is 85-115% MS acceptance range 75-125%.

QA/QC Batch 719160 (mg/L), QC Sample No: CQ10210 (CQ10210)

ICP Metals - Aqueous

Copper	BRL	0.0020	0.009	0.0092	NC	107			115			85 - 115	20
Lead	BRL	0.0010	<0.0010	<0.0010	NC	115			115			85 - 115	20

Comment:

Additional: LCS acceptance range is 85-115% MS acceptance range 75-125%.

If there are any questions regarding this data, please call Phoenix Client Services at extension 200.

RPD - Relative Percent Difference

LCS - Laboratory Control Sample

LCSD - Laboratory Control Sample Duplicate

MS - Matrix Spike

MS Dup - Matrix Spike Duplicate

NC - No Criteria

Intf - Interference

Phyllis Shiller, Laboratory Director

February 26, 2024

Monday, February 26, 2024

Criteria: NJ: DW

State: NJ

Sample Criteria Exceedances Report
GCQ10190 - LEADCONSULT

SampNo	Acode	Phoenix Analyte	Criteria	Result	RL	Criteria	RL Criteria	Analysis Units
--------	-------	-----------------	----------	--------	----	----------	----------------	-------------------

*** No Data to Display ***

Phoenix Laboratories does not assume responsibility for the data contained in this exceedance report. It is provided as an additional tool to identify requested criteria exceedences. All efforts are made to ensure the accuracy of the data (obtained from appropriate agencies). A lack of exceedence information does not necessarily suggest conformance to the criteria. It is ultimately the site professional's responsibility to determine appropriate compliance.



Environmental Laboratories, Inc.
587 East Middle Turnpike, P.O.Box 370, Manchester, CT 06045
Tel. (860) 645-1102 Fax (860) 645-0823



Analysis Comments

February 26, 2024

SDG I.D.: GCQ10190

The following analysis comments are made regarding exceptions to criteria not already noted in the Analysis Report or QA/QC Report: None.



NY/NJ/PA CHAIN OF CUSTODY RECORD

587 East Middle Turnpike, P.O. Box 370, Manchester, CT 06040

Email: info@phoenixlabs.com Fax (860) 645-0823

Client Services (860) 645-8726

Coolant: Yes ☐ No ☒
IPK ☐ ICE ☐

Temp 19.1°C Pg 1 of 1

Contact Options:

☒ Phone: 973-912-0222☐ Fax: 973-912-5227☒ Email: luke973@verizon.netCustomer: G. Luke Schroeder
Address: Lead Consulting & Inspection, Inc.
219 Main Street, P O Box 814
Chatham, NJ 07928Project Name: North Hudson Community Project P.O.
Street Address: 5800 Kennedy Blvd
City, State, Zip: West New York, NJ 07047
Quote #: L110220BAThis section MUST be
completed with
Bottle Quantities.

Client Sample - Information - Identification

Sampler's
Signature

Date: 1/23/24

Analysis
Request

Matrix Code:

DW=Drinking Water GW=Ground Water SW=Surface Water WW=Waste Water
RW=Raw Water SE=Sediment SL=Sludge S=Soil SD=Solid W=Wipe
OIL=Oil B=Bulk L=Liquid

PHOENIX USE ONLY

SAMPLE #	Customer Sample Identification	Sample Matrix	Date Sampled	Time Sampled
10190	L/L/KIT/SINK	DW	1/23/24	718
10191	L/LEV/KIT/SINK	DW	1/23/24	719A
10192	L/L/KIT/SINK	DW	1/23/24	717A
10193	L/L/GIRLS/SINK	DW	1/23/24	723A
10194	L/L/BOYS/SINK	DW	1/23/24	725A
10195	L/L/BOYS/SINK	DW	1/23/24	726A
10196	L/L/CR/SINK	DW	1/23/24	732A
10197	STFI/CR/SINK	DW	1/23/24	735A
10198	STFI/CR/SINK	DW	1/23/24	736A
10199	STFI/CR/SINK	DW	1/23/24	738A
10200	STFI/CR/SINK	DW	1/23/24	740A

LEAD & COPPER

GL Amber 8 oz. w/3PO4
Soil VOA Vial () oz
GL Soil container () oz
GL Soil container () oz
40 ml VOA Vial () oz
GL Amber 1000ml () oz
PL As is () 1250ml () 1500ml
PL H2SO4 () 250ml () 1000ml
PL NaOH 250ml
Bacteria Bottle witho
Bacteria Bottle as is

Relinquished by:

G. Luke Schroeder

Accepted by:

Date:

Time:

Turnaround:

☐ 1 Day*☐ 2 Days*☐ 3 Days*☐ 5 Days☒ 10 Days☐ Other

* SURCHARGE

NJ

☐ Res. Criteria
☐ Non-Res. Criteria
☐ Impact to GW Soil
Cleanup Criteria
☐ Impact to GW
soil screen
Criteria
☐ GW Criteria

Data Package:

☐ NJ Reduced Deliv. *
☐ NY Enhanced (ASP B) *
☐ Other

NY

☐ TOGS GW
☐ CP-51 SOIL
☐ 375SCO
☐ Unrestricted Soil
☐ 375SCO
Residential Soil
☐ 375SCO
Residential
☐ 375SCO
Commercial Soil
☐ 375SCO
Industrial Soil
☐ Subpart 5 DW

PA

☐ Clean Fill Limits
☐ PA-GW
☐ Reg Fill Limits
☐ PA Soil Restricted
☐ PA Soil non-restricted

State Samples Collected?

Comments, Special Requirements or Regulations:

Data Format:

☐ Phoenix Std Report
☐ Excel
☒ PDF
☐ GIS/Key
☐ EQuIS
☐ NJ Hazsite EDD
☐ NY EZ EDD (ASP)
☐ Other



NY/NJ/PA CHAIN OF CUSTODY RECORD

587 East Middle Turnpike, P.O. Box 370, Manchester, CT 06040
 Email: info@phoenixlabs.com Fax (860) 645-0823
 Client Services (860) 645-8726

Coolant: IPK ☐ Yes ☐ No ☒
 Temp 14.18 Pg of

Contact Options:

☒ Phone: 973-912-0222
☐ Fax: 973-912-5227
☒ Email: luke973@verizon.net

Customer: G. Luke Schroeder
 Address: Lead Consulting & Inspection, Inc.
 219 Main Street, P O Box 814
 Chatham, NJ 07928

Project Name: North Hudson Community A Project P.O.
 Street Address: 5800 KENNEDY BLVD.
 City, State, Zip: West New York, NJ 07047
 Quote #: L110220BA

This section MUST be completed with Bottle Quantities.

Client Sample Information / Identification

Sampler's Signature: *[Signature]* Date: 1/23/24

Analysis Request

Matrix Code:

DW=Drinking Water GW=Ground Water SW=Surface Water WW=Waste Water
 RW=Raw Water SE=Sediment SL=Sludge S=Soil SD=Solid W=Wipe
 OIL=Oil B=Bulk L=Liquid

PHOENIX USE ONLY

SAMPLE #	Customer Sample Identification	Sample Matrix	Date Sampled	Time Sampled
10201	1st F/CR/RIGHT SINK	DW	1/23/24	743AM
10202	1st F/CR/LEFT SINK	DW	1/23/24	744A
10203	1st F/CR/BATH	DW	1/23/24	745A
10204	1st F/CR/SINK	DW	1/23/24	750A
10205	1st F/GIRLS SINK	DW	1/23/24	752A
10206	1st F/BATH SINK	DW	1/23/24	755A
10207	2nd F/BATH/RIGHT SINK	DW	1/23/24	805A
10208	2nd F/BATH/LEFT SINK	DW	1/23/24	807A
10209	2nd F/BATH/RIGHT SINK	DW	1/23/24	815A
10210	2nd F/BATH/LEFT SINK	DW	1/23/24	817A

LEAD & COPPER

GL Amber 8 oz. w/ H3PO4
 Soil VOA Vials () oz
 GL Soil container () oz
 40 ml VOA Vial () oz
 GL Amber 1000ml () as is () HCl
 PL As is () 1250ml () 1500ml () 1000ml
 PL H2SO4 250ml () 1500ml
 PL HNO3 250ml
 Bacteria Bottle with/without

Relinquished by:

G. Luke Schroeder

Accepted by:

Date:

Time:

Turnaround:

☐ 1 Day*
☐ 2 Days*
☐ 3 Days*
☐ 5 Days
☒ 10 Days
☐ Other

*SURCHARGE

NJ

☐ Res. Criteria
☐ Non-Res. Criteria
☐ Impact to GW Soil Cleanup Criteria
☐ Impact to GW soil screen Criteria
☐ GW Criteria

Data Package:

☐ NJ Reduced Deliv. * ☐ Other
☐ NY Enhanced (ASP B) *

NY

☐ TOGS GW
☐ CP-51 SOIL
☐ 375SCO
☐ Unrestricted Soil
☐ 375SCO Residential Soil
☐ 375SCO Residential
☐ 375SCO Commercial Soil
☐ 375SCO Industrial Soil
☐ Subpart 5 DW

PA

☐ Clean Fill Limits
☐ PA-GW
☐ Reg Fill Limits
☐ PA Soil Restricted
☐ PA Soil non-restricted

State Samples Collected?

Comments, Special Requirements or Regulations:

Data Format:

☐ Phoenix Std Report ☐ EQuIS
☐ Excel ☐ NJ Hazsite EDD
☒ PDF ☐ NY EZ EDD (ASP)
☐ GIS/Key ☐ Other

Fire Alarm Floor Plans

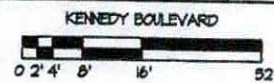

- DRYING NO.
A2.4a

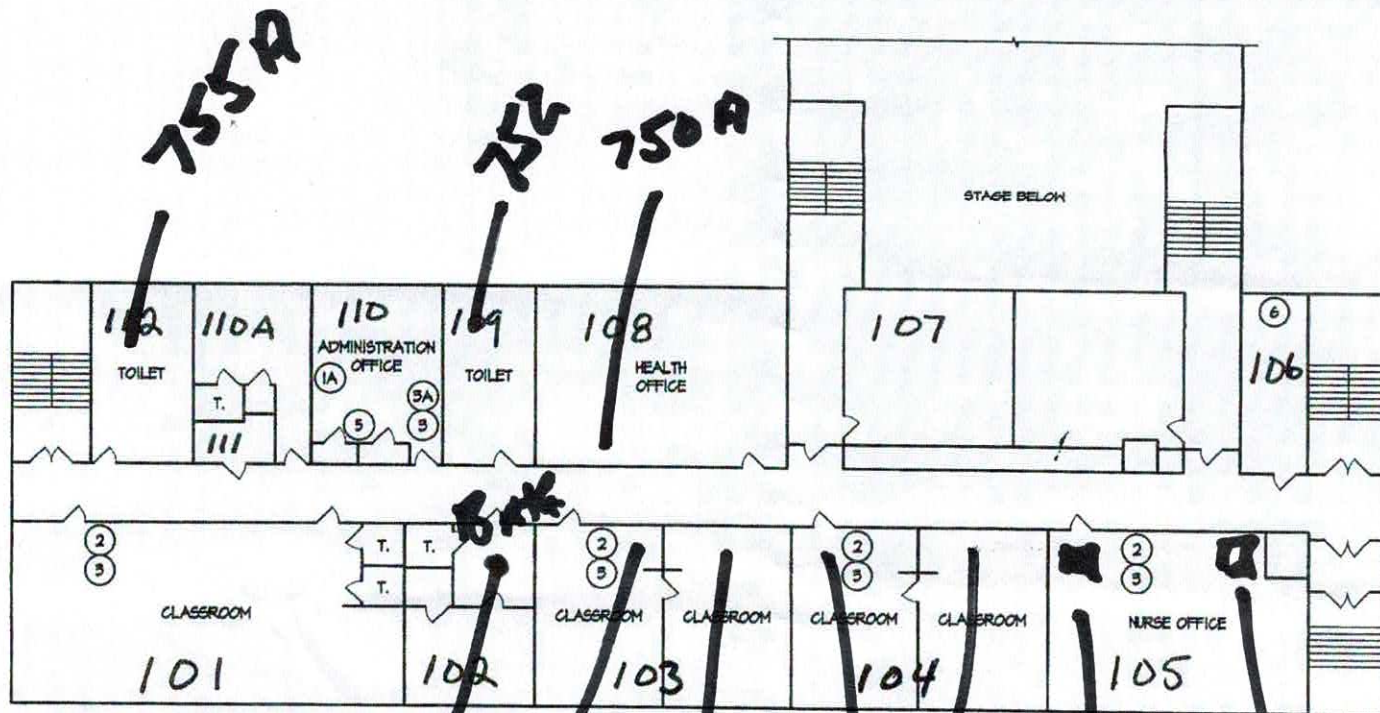

PLAN KEY NOTES:

- ① EXISTING DOOR BUZZER, INTERCOM AND CAMERA
- ①A EXISTING ENTRANCE DOOR INTERCOM AND DOOR RELEASE
- ② NEW MONITOR AND WALL MOUNT BRACKET. PROVIDE POWER AS REQUIRED.
- ③ NEW PANIC BUTTON
- ③A NEW PANIC BUTTON ALARM CONTROL PANEL

PLAN KEY NOTES:

- ④ NEW EXTERIOR BULLET CAMERA FOR VIEW OF PARKING LOT AND LOADING DOOR
- ④A NEW INTERIOR DOME CAMERA
- ⑤ LOCATION OF EXISTING SURVEILLANCE SYSTEM
- ⑥ EXISTING TELEPHONE DEMARC

1 FIRST FLOOR PLAN - 5800 KENNEDY BLVD.
SCALE: 1/16" = 1'-0"

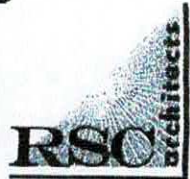

506 Anderson Avenue
Suite 202
CHESHAM, N.J. 07015
T: 201.941.3040
F: 201.941.3060
www.rscarchitects.com

DATE	DESCRIPTION
10/1/00	10/1/00
10/1/00	10/1/00
10/1/00	10/1/00
10/1/00	10/1/00
10/1/00	10/1/00
10/1/00	10/1/00
10/1/00	10/1/00
10/1/00	10/1/00
10/1/00	10/1/00
10/1/00	10/1/00

For all drawings and specifications, the user is responsible for obtaining the necessary permits and approvals from the appropriate authorities.

NORTH HUDSON
COMMUNITY
ACTION CORP.
5800 KENNEDY BLVD.
WEST NEW YORK, NEW JERSEY
PROJECT NO. - 2012-002

REV	DATE	DESCRIPTION
1	10/1/00	ISSUED FOR PERMITS

5800 KENNEDY BLVD.
FIRST FLOOR PLAN
ALTERNATE #4
DESIGNED BY: RSC
DRAWN BY: CF
A2.4b

817 ✓
825 R
807 H
805 R1

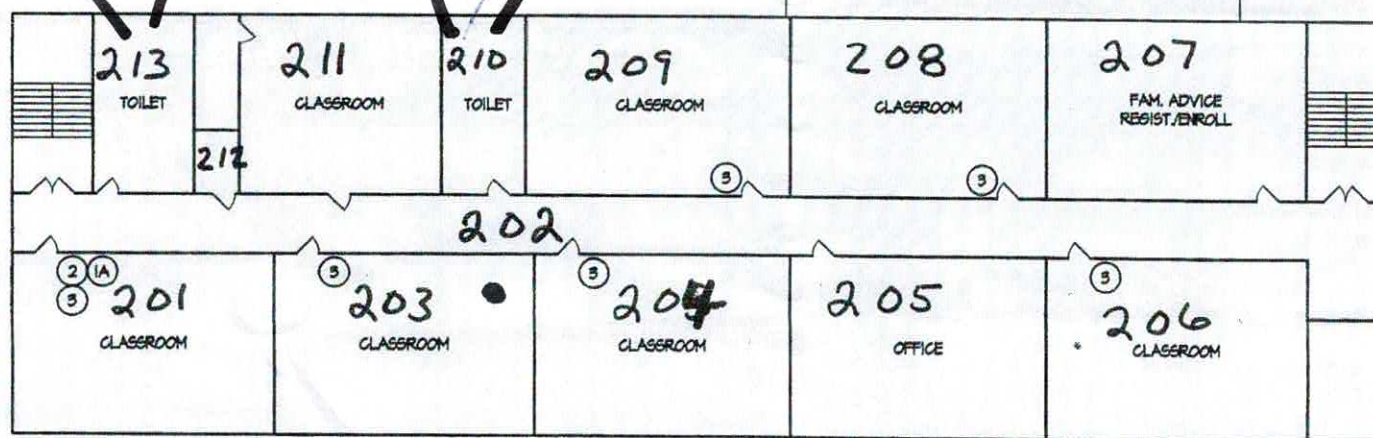

PLAN KEY NOTES:

- ① EXISTING DOOR BUZZER, INTERCOM AND CAMERA
- ①A EXISTING ENTRANCE DOOR INTERCOM AND DOOR RELEASE
- ② NEW MONITOR AND WALL MOUNT BRACKET. PROVIDE POWER AS REQUIRED.
- ③ NEW PANIC BUTTON
- ③A NEW PANIC BUTTON ALARM CONTROL PANEL

PLAN KEY NOTES:

- ④ NEW EXTERIOR BULLET CAMERA FOR VIEW OF PARKING LOT AND LOADING DOOR
- ④A NEW INTERIOR DOME CAMERA
- ⑤ LOCATION OF EXISTING SURVEILLANCE SYSTEM
- ⑥ EXISTING TELEPHONE DEMARC

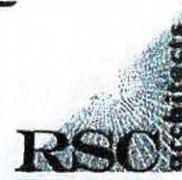

590 Anderson Avenue
Suite 202
Cliffside Park, NJ 07010
t: 201.041.3040
f: 201.041.3050
www.rscarchitects.com

DESCRIPTION	DATE
REVISION	
REVISION	
REVISION	
REVISION	
REVISION	
REVISION	
REVISION	
REVISION	
REVISION	

THIS DOCUMENT IS THE PROPERTY OF RSC ARCHITECTS. IT IS TO BE USED ONLY FOR THE PROJECT AND SITE SPECIFICALLY IDENTIFIED HEREON. IT IS NOT TO BE REPRODUCED, COPIED, OR TRANSMITTED IN ANY FORM OR BY ANY MEANS, ELECTRONIC OR MECHANICAL, INCLUDING PHOTOCOPYING, RECORDING, OR BY ANY INFORMATION STORAGE AND RETRIEVAL SYSTEM, WITHOUT THE WRITTEN PERMISSION OF RSC ARCHITECTS.

**NORTH HUDSON
COMMUNITY
ACTION CORP.**
SURVEILLANCE SYSTEMS
FOR
**EARLY CHILDHOOD
FACILITIES**
5800 KENNEDY BLVD.
WEST NEW YORK, NEW JERSEY
PROJECT NO. 2013003

NO. 1	DATE	DESCRIPTION
001/13	08/01/13	ISSUED FOR BID

DRAWING TITLE
5800 KENNEDY BLVD.
SECOND FLOOR PLAN
ALTERNATE #4
CHECKED BY: PA. DRAWN BY: EP.
DATE: 08/01/13

A2.4c

DATE: 08/01/13

1 SECOND FLOOR PLAN - 5800 KENNEDY BLVD.
SCALE: 1/16" = 1'-0"